



mgs architecture

T 216.520.1551 F 216.520.1567  
7100 E. Pleasant Valley Rd., Suite 320, Cleveland, OH 44131

Seal:

A Project for:

**zeisler morgan properties Ltd.**  
Development - Investment - Leasing - Management

**RIDGE PARK SQUARE**  
BROOKLYN, OH

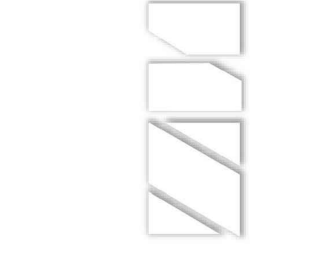

Client:

**RIDGE PARK SQUARE, LLC**  
3000 CHAGRIN BLVD, SUITE 100  
CLEVELAND, OH

Revisions:	
Revision 1	06.04.18
Revision 2	07.09.18
Revision 3	07.23.18

No.	Description	Date
Project No.:		17.316.01
Drawn By:		
Reviewed By:		
Scale:		AS NOTED
Date:		05-08-18
Filename:		
Sheet Title:		

SITE-LEASE PLAN

Sheet #:

LP-1

© MCG ARCHITECTS 2018 ALL RIGHTS RESERVED

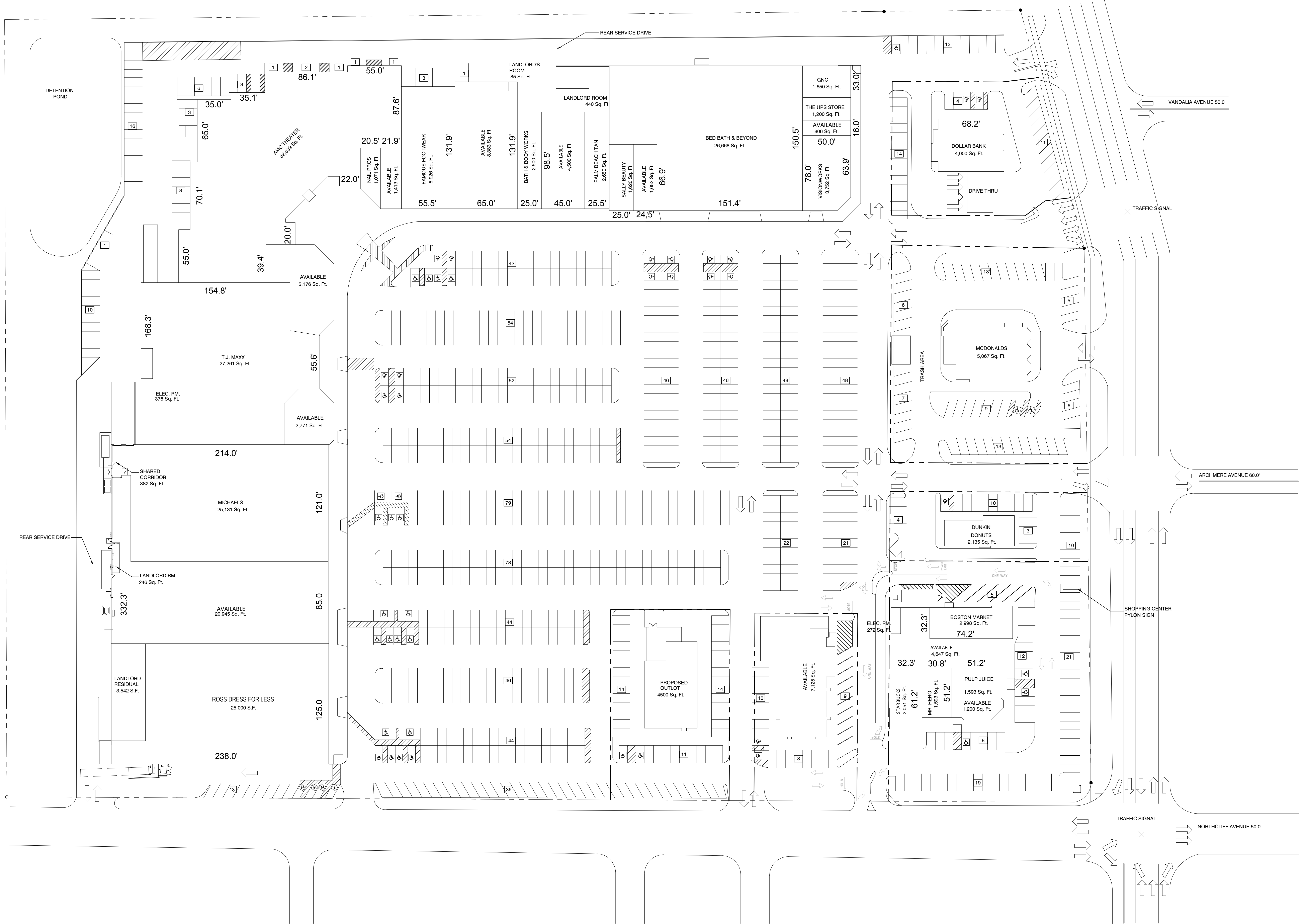

RIDGE PARK SQUARE

NORTHCLIFF AVE.

SHOPPING CENTER  
PYLON SIGN

SHOPPING CENTER  
PYLON SIGN

DELORA AVE.

RIDGE ROAD

FLOWERDALE AVE.

HIGHWAY I-480  
PYLON SIGN

INTERSTATE 480

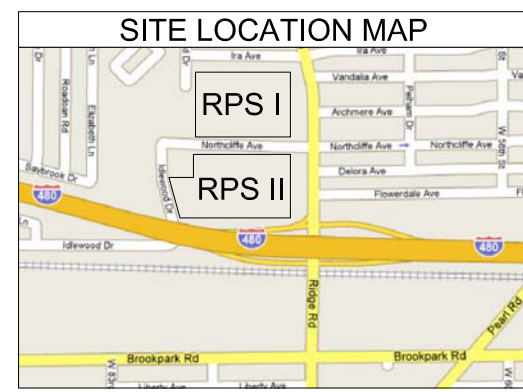

SITE DATA	
LAND AREA:	27.31 ACRES
TOTAL GLA:	321,869 SQ.FT.
TOTAL PARKING:	1,696 SPACES
TOTAL PARKING RATIO:	5.27 / 1000 S.F. GLA



SITE / LEASE PLAN

SCALE: 1"=100'-0"

NORTH

REVISIONS	BY

**zeisler morgan properties ltd.**  
 30000 CHAGRIN BLVD. SUITE #100  
 CELVELAND, OHIO 44124  
 (216-464-5255)  
 WWW.ZEISLERMORGAN.COM



**RIDGE PARK SQUARE II**  
 RIDGE ROAD & NORTHCLIFF AVE.  
 BROOKLYN, OHIO

DRAWN
CHECKED
DATE 02.06.14
SCALE 1" = 100'-0"
JOB NUMBER

SHEET  
**LP-1**  
 OF SHEETS